

CAPE COD PATHWAYS

MAP 3

-  **Main Trail**
-  **North Loop**
-  **South Loop**
-  **Public Parking**
-  **Rail Road**
-  **State / US Route**
-  **Paved Roads**
-  **Buildings**
-  **Unimproved Trails**
-  **Water Bodies**
-  **Wetlands / Marsh**

0 625 1250 feet

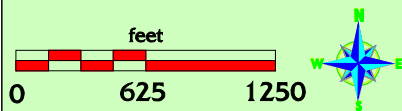

Prepared By
The Town of Barnstable
G.I.S. Unit
File: Master_Pathway3.dgn 6/27/2006 dstp
revised 10/25/2016

CONTINUED ON MAP 2

PRIVATE PROPERTY

CCCC LOT #7

CCCC LOT #3

Cape Cod Community College

Exit 6

SHOOTFLYING HILL ROAD

IYANNOUGH ROAD

OLD NECK LANE

CRANBERRY LANE

ROUTE 6

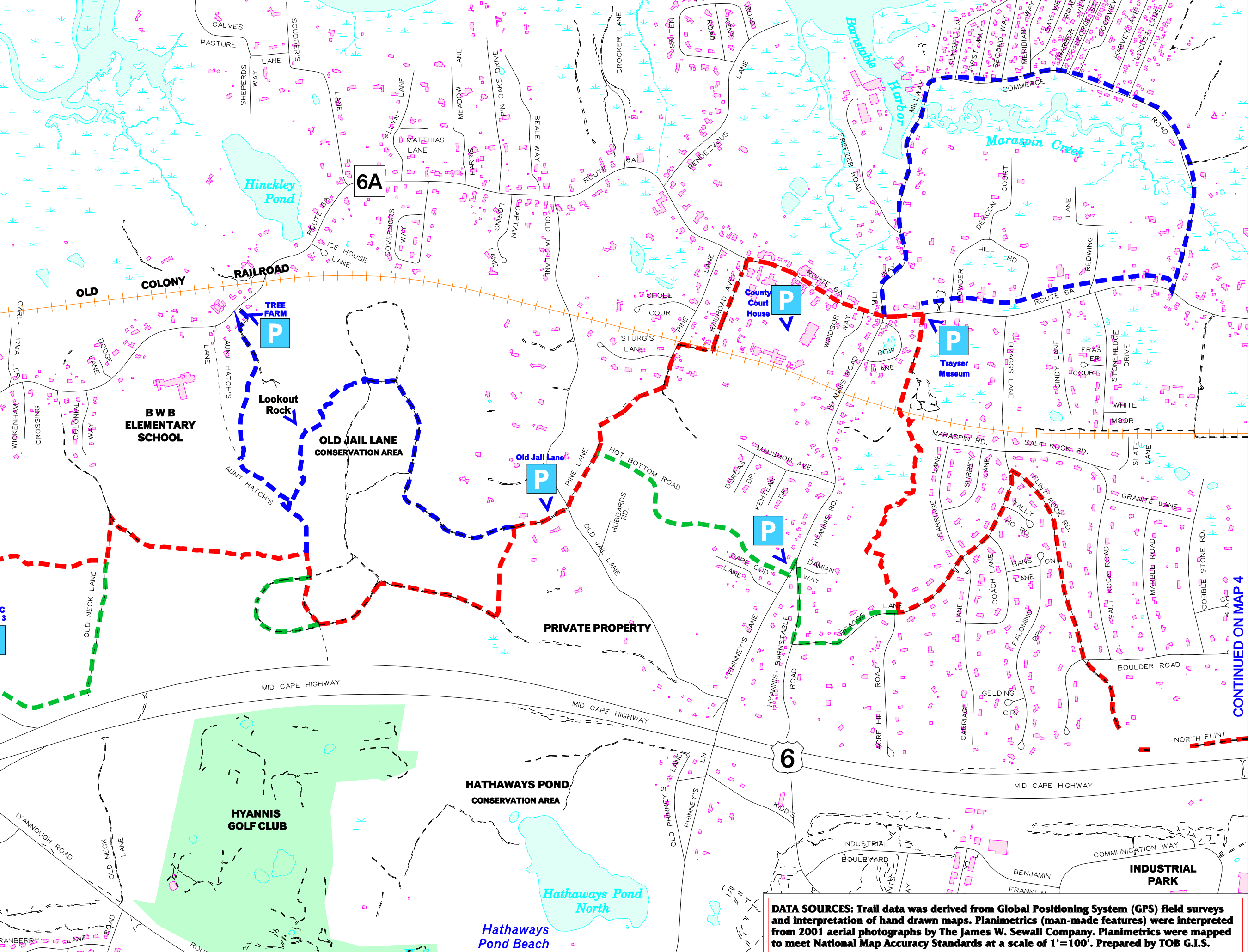

CONTINUED ON MAP 4

DATA SOURCES: Trail data was derived from Global Positioning System (GPS) field surveys and interpretation of hand drawn maps. Planimetrics (man-made features) were interpreted from 2001 aerial photographs by The James W. Sewall Company. Planimetrics were mapped to meet National Map Accuracy Standards at a scale of 1"=100'. Prepared by TOB G.I.S.